

# Home-based Beauty Businesses

## What is a home-based beauty business?

A home-based beauty business is any business that conducts beauty therapies, skin piercing, colonic irrigation, or similar procedures from home. There are many benefits of operating a home-based beauty business, however they are generally only suitable for small scale businesses with limited staff and clients.

## Do I need to register a home-based food business?

If you are intending to operate a home-based beauty business, you must register with the Environmental Health Department at Council prior to operating. You may also need permits from [Town Planning](#) and [Building](#) in addition to your registration with Environmental Health. You must check with these departments before operating.

A good place to start is by speaking to our Small Business Support Officer, they can assist you in finding out what permits from which departments you may need. You can submit a *Beauty Business Application form* on our website, or in person at the Civic Centre.

## What risk type is my beauty business?

Your risk type will depend on the type of procedures you are intending on offering. Businesses are categorised into low, medium, or high-risk groups based on the risk to public health. It is important to consider all of the procedures you will be offering prior to lodging your application to Environmental Health as this information is required to make a proper assessment of your risk type.

The table below shows registerable procedures in each risk category:

Low	Medium	High
<ul style="list-style-type: none"><li>– Hairdressing</li><li>– Spray tanning</li><li>– Facials - application of creams etc and steam only</li></ul>	<ul style="list-style-type: none"><li>– Hair removal (waxing, threading, epilation, laser hair removal)</li><li>– Laser tattoo removal</li><li>– Eyelash tinting</li><li>– Eyelash extensions</li></ul>	<ul style="list-style-type: none"><li>– Tattooing</li><li>– Piercing</li><li>– Colonics</li><li>– Skin needling</li><li>– Electrolysis</li></ul>

<ul style="list-style-type: none"> <li>- Makeup application</li> <li>- Eyebrow tinting</li> </ul>	<ul style="list-style-type: none"> <li>- Microdermabrasion</li> <li>- Manicures/pedicures</li> <li>- Ear lobe piercing with a gun</li> <li>- Teeth whitening</li> </ul>	<ul style="list-style-type: none"> <li>- Microblading</li> <li>- Wet cupping</li> </ul>
---	---	---

## Do I need to submit plans?

As part of your application, you will be required to submit plans of your proposal. These do not need to be drawn by a draftsman or an architect, however they will need to clearly demonstrate the proposed locations of all your fixtures and fittings and specify the materials/finishes used. Your plans will form part of a formal plans assessment made by an Environmental Health Officer (EHO), plans and photographs are highly encouraged to be able to make an informed decision on your registration requirements.

An example of a hand drawn plan using 'Paint' can be found below:

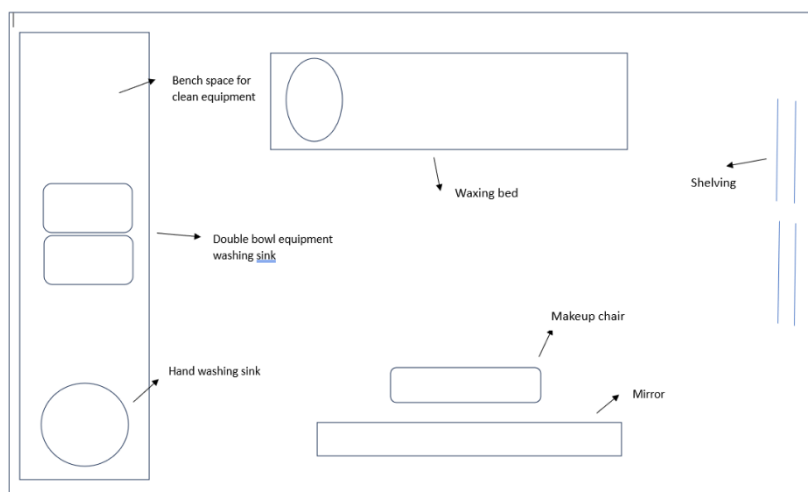

### Finishes and materials:

Flooring = Laminate  
 Walls = Painted with waterproof paint.  
 Equipment washing sink = Stainless steel double bowl sink with 1 mixer tap (depth 480mm, height 156mm, width 1135mm)  
 Handwash basin = ceramic 12.5L basin (depth 300mm, height 255, width 200mm)

## What if I want to operate a mobile business?

Low-risk procedures may be registered with Council as mobile businesses, that is, travelling from one location to another to conduct beauty therapy. Medium and high-risk businesses are not permitted to conduct mobile procedures.

Low risk beauty businesses must register their "principal place of business" but are exempt from any requirement to register every premises on which they conduct their business. For example, a hairdresser that goes into people's homes, is not required to register every home where they conduct hairdressing, only their principal place of business i.e., their own home. You will still be required to demonstrate how you will maintain hygienic practices upon inspection of your principal place of business.

## What are the fit-out requirements?

### Hand washing sinks

All beauty businesses need somewhere for therapists to wash their hands before undertaking a treatment. Requirements for the hand washing sink are below:

- Must be within the room you intend to perform beauty procedures in. If you are working out of multiple rooms, each room must have a separate handwash basin.
- Must be installed for the dedicated purpose of washing hands. This cannot be a mixed-use sink like an ensuite, toilet, or kitchen sink as they pose a contamination risk.
- Must be permanently plumbed with hot and cold water.
- If you are performing high-risk services, a hands-free tap must be used.
- If the only service you offer is hairdressing, a hair wash basin can be used as a hand washing sink.

### Equipment washing sinks

If you have reusable equipment such as brushes, scissors, sponges, bowls, cuticle nippers and so forth, you will need a designated place to wash your equipment. Your equipment washing sink requirements will depend on the amount of reusable equipment you have; an Environmental Health Officer will decide during your plan assessment based on the following:

- The amount of disposable equipment you use.
- The amount of reusable equipment you use.
- Your risk category.
- The number of clients you see per day.

If you are performing high-risk procedures and are not using disposable skin penetrative equipment, you will need an entirely separate double bowl sink installed for the dedicated purpose of sterilising equipment. For example, reusable skin piercing needles that get washed, rinsed, and run through an autoclave.

### Treatment room

The treatment or procedure room must be able to be cleaned effectively with appropriate flooring and wall materials. Carpet, exposed brick, or unsealed timber are not appropriate materials within a beauty therapy business.

## Contact us

Public and Environmental Health Unit  
45 Princes Hwy, WERRIBEE VIC 3030  
(03) 9742 0738  
[ehadmin@wyndham.vic.gov.au](mailto:ehadmin@wyndham.vic.gov.au)