

Drawing name: M:\Engineering Services\Engineering Design Projects\RESOURCE References\WCC Standard Drawings\SD10-1.dwg (28 May, 2024)

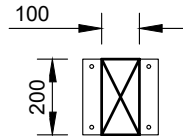

**PLAN VIEW**

COLLAPSABLE BOLLARD STEEL PLATE FIRMLY FIXED TO EXISTING CONCRETE. THE CONTRACTOR SHALL ENSURE THAT ANY FITTINGS AND FIXTURES FINISH FLUSH WITH TOP OF GROUND PLATE AND SHALL NOT CREATE TRIP HAZARDS

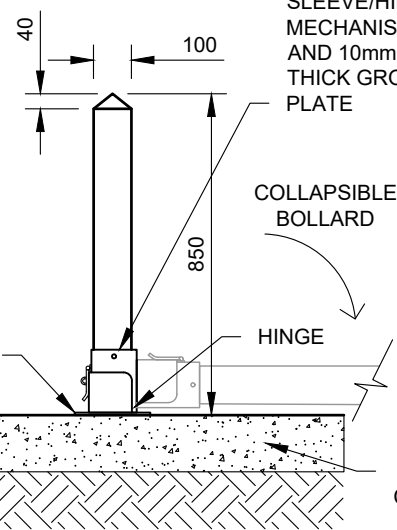

**SIDE ELEVATION**

FABRICATED HOT DIPPED GALVANISED STEEL SLEEVE/HINGED MECHANISM AND 10mm THICK GROUND PLATE

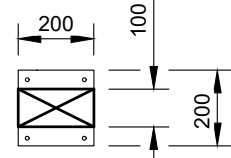

**PLAN VIEW**

60MM DIAMETER HOLE DESIGNED AS A WEAK SPOT TO BREAK AT THIS POINT IN THE EVENT OF A COLLISION

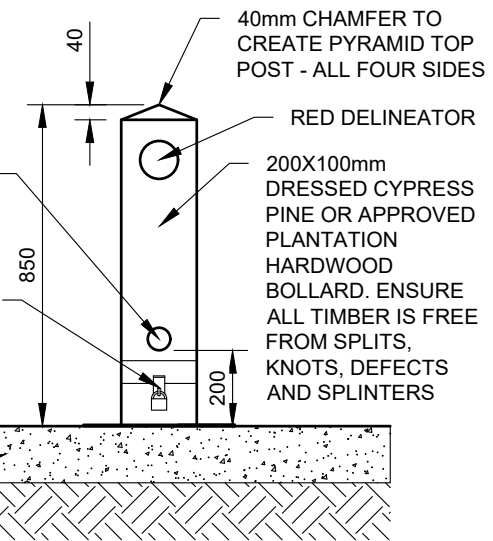

**FRONT ELEVATION**

LATCH AND PADLOCK LOCK TO BE PURCHASED FROM COUNCIL (TYPE A5-101)

**MOUNTED INTO CONCRETE**

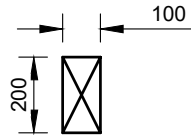

**PLAN VIEW**

REFER TO "MOUNTED INTO CONCRETE" DRAWINGS ABOVE FOR BOLLARD DETAIL

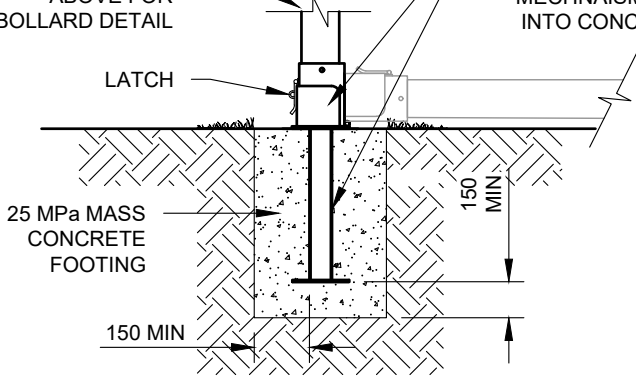

**SIDE ELEVATION**

FABRICATED HOT DIPPED GALVANISED STEEL SLEEVE / HINGE MECHANISM SET DIRECTLY INTO CONCRETE FOOTING

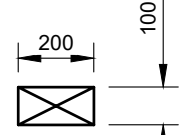

**PLAN VIEW**

REFER TO "MOUNTED INTO CONCRETE" DRAWINGS ABOVE FOR BOLLARD DETAIL

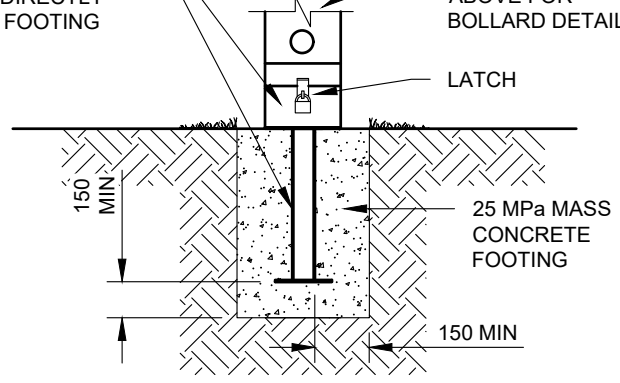

**FRONT ELEVATION**

**MOUNTED INTO NATURAL GROUND**

**NOTES:**

- BOLLARDS TO BE OFFSET AT LEAST 1m FROM BACK OF KERB, UNLESS OTHERWISE APPROVED BY COUNCIL.
- ALL DIMENSIONS ARE IN MILLIMETRES UNLESS OTHERWISE SHOWN.
- CONCRETE STRENGTH OF 25MPa AT 28 DAYS.
- BOLLARDS ARE TO BE INSTALLED WITH HOLES FACING PERPENDICULAR TO THE ROAD.
- SPACING BETWEEN BOLLARDS TO BE 1.6m INCLUDING WHEN LOCATED ACROSS A PATH.
- WHERE BOLLARDS ARE INSTALLED IN THE CENTRE OF A SHARED USER PATH, THE MARKINGS AND REFLECTIVE TAPE OF THAT BOLLARD ARE TO BE IN ACCORDANCE WITH THE AUSTRROADS GUIDE TO ROAD DESIGN PART 6A: PATHS FOR WALKING AND CYCLING.

| REV | AMENDMENTS                           | APPROVAL   | DATE       |
|-----|--------------------------------------|------------|------------|
| C   | ADDED NOTE 4                         |            | 12-01-2010 |
| D   | UPDATED TO REFLECT CURRENT STANDARDS | M.BRIGANDI | 21-05-24   |
|     |                                      |            |            |
|     |                                      |            |            |
|     |                                      |            |            |
|     |                                      |            |            |
|     |                                      |            |            |
|     |                                      |            |            |
|     |                                      |            |            |
|     |                                      |            |            |

**COLLAPSABLE BOLLARD DETAIL**

45 PRINCES HIGHWAY  
WERRIBEE, VIC 3030

TEL: 1300 023 411  
wyndham.vic.gov.au

|                               |
|-------------------------------|
| CAD FILE: SD10-1.DWG          |
| DRAWN DATE: FEB 2024          |
| REVISION: D                   |
| DRAWING NO.:<br><b>SD10-1</b> |

GENERAL NOTES: -DRAWINGS ARE NOT TO SCALE.  
 -ALL MEASUREMENTS ARE IN MILLIMETERS UNLESS OTHERWISE STATED.  
 -FOR UP TO DATE DRAWINGS PLEASE CHECK WYNDHAM CITY COUNCIL WEBSITE.  
 -ALL STANDARD DRAWINGS TO BE USED IN CONJUNCTION WITH SD1-1 (STANDARD DRAWINGS CONDITIONS OF USE).