

2025 Federal Election **Priorities for** *Gellibrand*







A Message From Our Mayor

As Mayor of Wyndham City Council, I want to congratulate all candidates standing for the Federal Electorate of Gellibrand in this year's Federal Election.

Gellibrand covers important areas of the Western Suburbs landscape, such as Laverton and Point Cook. Wyndham is committed to seeing the success of these areas, given their importance to our State's housing, agricultural and industrial bases.

At every State and Federal election, it's critical that Wyndham residents are given a choice of high quality candidates who can present their vision for the future of our area.

The Werribee by-election held in February this year showed growing concerns around the ability of government to deliver the necessary services and infrastructure to support the level of growth we've seen in the West in recent years.

This Federal Election is a renewed opportunity for us to seek support for the many projects that Wyndham requires to sustain and support this growth, and this brochure includes many of the game-changing projects that aim to meet these community needs.

As Mayor, I will be seeking to meet with all the candidates on behalf of our community to demonstrate the importance that Wyndham places on our engaging with representations and discussing the needed future-building investment that will service our residents for generations.

I look forward to engaging with you throughout the 2025 Federal Election,

A handwritten signature in black ink, appearing to read 'Mia Shaw', with a long horizontal flourish extending to the right.

Mayor Mia Shaw



Westlink Stage 2

Request:

A Federal funding contribution of **\$88 million**. This funding request forms part of the overall funding requirement of the project, with expected further required contributions from State Government (**\$81 million**) and Wyndham City Council (**\$27 million**).

This Federal Contribution request includes:

- design and construction of the Bridge across the Werribee River – **\$34 million**
- duplication and upgrade of Ballan Road and Armstrong Road intersection – **\$14 million**
- duplication and upgrade of the bridge over the Regional Rail Link (RRL) incorporating the Ballan Road and Armstrong Road Intersection – **\$40 million**

About the Project/Benefits:

Westlink Stage 2 will boost connections through one of Australia's fastest growing areas.

This project will connect the large growth communities of Manor Lakes, Wyndham Vale and Tarneit that are currently divided by the Werribee River, by connecting Ballan Road in Wyndham Vale to Sayers Road in Tarneit.

As a continuous link connecting developing residential areas to the Princes Freeway, Westlink will also provide an alternative for traffic currently funnelled through the Werribee City Centre.

Once all stages are delivered, Wyndham Westlink will support traffic reduction, tourism and businesses around the new A-League Stadium in Tarneit and provide faster access to local jobs throughout Melbourne's West.

As a significant connector through the western suburbs, the delivery of Westlink Stage 2 will also support the Victorian economy by leveraging the faster realisation of land tax, stamp duty and developer contributions, as well as additional Growth Area Infrastructure Charges.

Further, this critical bridge and road infrastructure link will provide the connection and accessibility to some of our other future-building investment opportunities including:

- Employment opportunities in the Western State Significant Industrial Precinct (WSSIP)
- Wyndham Stadium Precinct
- Riverdale aquatic and recreational centre.

This investment will complement a four-lane extension of Ison Road over the Werribee rail line that is currently under construction and an extension from the rail line to the Werribee Main Road and Princes Freeway Interchange that has been funded.



Outer Metropolitan Ring Road (OMR)

Request:

\$20 million funding to deliver a detailed Business Case for the Outer Metropolitan Ring Road.

About the Project:

The Outer Metropolitan Ring (OMR) Transport Corridor is a proposed 100-kilometre high-speed transport link that provides connection from west of Werribee to the Hume Freeway at Kalkallo.

It would combine a proposed freeway with railway tracks in the median for interstate freight and high-speed passenger trains.

The OMR will connect key transport hubs such as Melbourne Airport, Avalon Airport, the Port of Geelong, the beverage Interstate Freight Terminal, the proposed Western Intermodal Freight Terminal and proposed Bay West Port Precinct.

The Victorian Government defined the corridor through application of a Public Acquisition Overlay in 2010. This allows for compulsory acquisition of property when required.

The OMR is expected to lift productivity and growth through improved transport connectivity in the north and west of Melbourne between key employment, residential growth areas and by linking key transport hubs.

The 2008 Planning Assessment Report by VicRoads describes the road as providing “the backbone for the future transport network planning in Melbourne’s growing northern and western suburbs in coming years.”

The OMR is on Infrastructure Australia’s (IA) Infrastructure Priority List. Modelling by Infrastructure Australia in 2017 estimates the total capital expenditure cost is between \$17.2 billion and \$34.7 billion in total.



Truganina Railway Station

Request:

Funding towards the construction of the Truganina Railway Station.

About the Project:

Better rail connectivity between Wyndham and the Melbourne metro area will improve access to employment, economic and educational opportunities.

The construction of a new station in Truganina will ease the pressure on Tarneit railway station and surrounding roads by improving accessibility for residents living in the new estates north of the Regional Rail Link.

The Station will create public transport accessibility to employment opportunities in the Western State Significant Industrial Precinct (WSSIP), especially for residents in Wyndham's west. Currently, the WSSIP is only served by bus services departing from Laverton Railway Station on the Werribee line or Sunshine Railway Station.

The Regional Rail link opened in 2015 and was constructed with a \$3.2 billion contribution of federal funding. The RRL was designed to accommodate six railway stations. However, only two railway stations have been constructed at this time. Truganina was one of the proposed stations.

The Victorian State Government committed funding for the design of a station in 2022.

The population of Truganina is expected to swell in the next 15 years from 35,124 in the 2021 census to an estimated 55,556 by 2046. Truganina Railway Station will provide a key transport connection for many of these residents.



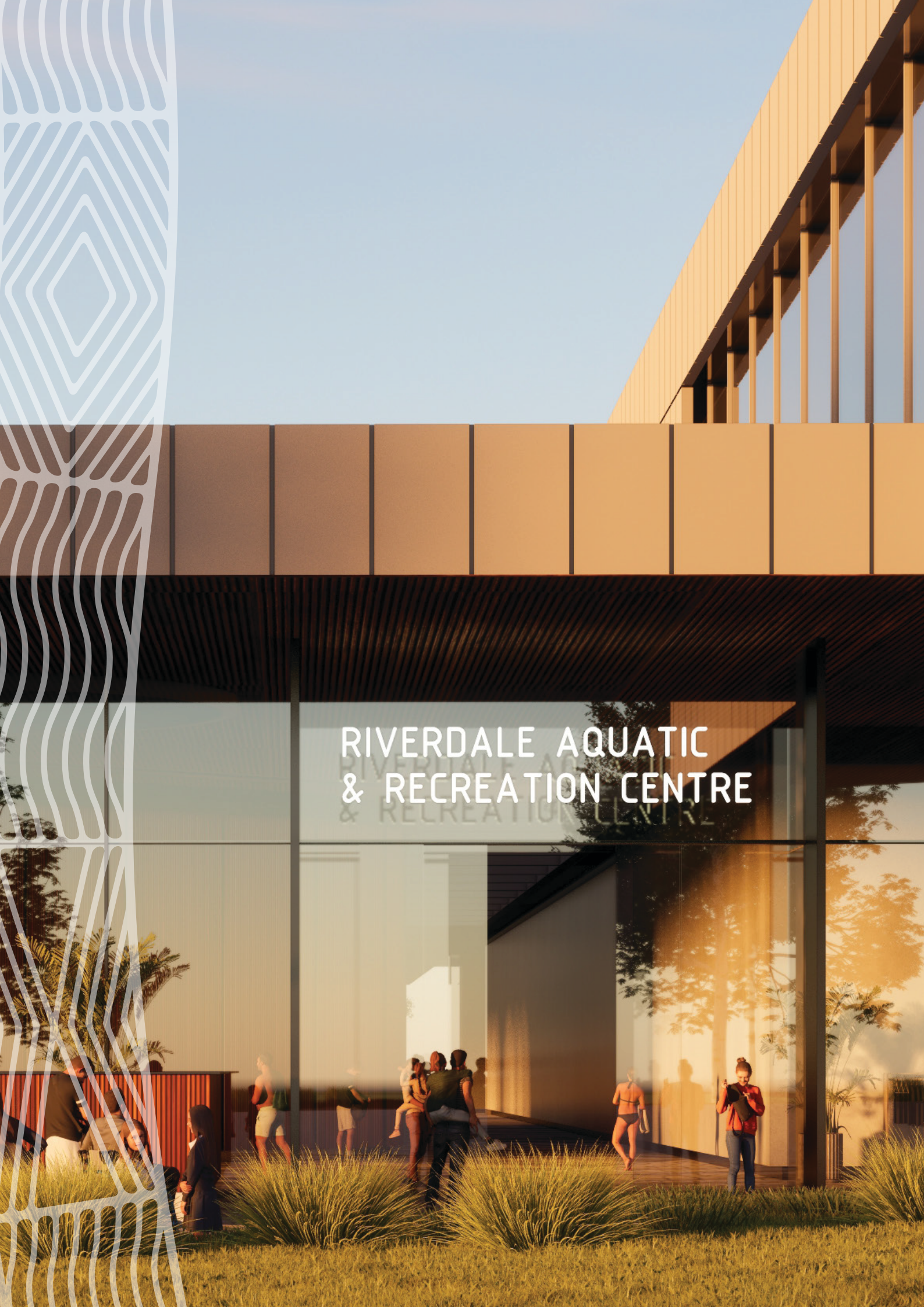

RIVERDALE AQUATIC
& RECREATION CENTRE

Riverdale Aquatic Centre

Request:

\$40 million funding contribution to deliver a new aquatic centre in Tarneit.

About the Project:

The proposed Riverdale Aquatic Centre will meet the needs of Wyndham's growing population – increasing community wellbeing, strengthening local connections and improving water safety for residents.

The Riverdale Aquatic and Indoor Sports Centre is proposed to feature a regional aquatic centre (25m pool, large warm water pool, learn to swim pool and aquaplay with leisure water), a health club (gymnasium, spin and group fitness spaces), nine indoor multi-use sport courts, café, creche, meeting rooms, operator and sport administration office areas and associated amenities.

The Riverdale Aquatic and Indoor Sports Centre will aim to draw over 2 million visitations per annum and will be Wyndham's largest indoor facility.

Studies have found Aquatic and Recreation Centres (ARC) improve physical and mental health and wellbeing and help build strong social networks. A recent study by PWC showed that there is a \$4.87 social return on investment for every dollar spent on an aquatic facility in capital cities.

Analysis conducted by Infrastructure Victoria found Wyndham has one aquatic and recreation centre (ARC) for approximately 150,000 people, compared to the City of Greater Geelong which has one ARC for approximately 75,000 people.

Stage 1 of the project is expected to cost \$119.9 million and will provide for the incorporation of the regional aquatic centre and health club, café, offices and amenities as recommended in the Feasibility & Concept Plan.

The site is located on the fringe of the future Riverdale Town Centre, opposite the future Town Square and nearby other civic infrastructure (community centre, library) and future train station. The facility is set to complement the high-performance sport precinct being developed to the north of the train line by Western Melbourne Group.



Tarneit Indoor Sports Centre

Request:

\$30 million funding towards the Tarneit Indoor Sports Centre. This funding request forms part of the overall funding requirement of the project (Estimated: **\$60million**).

About the Project:

The Tarneit Indoor Sports Centre is a critical infrastructure project designed to meet the growing demand for high-quality sporting facilities in Wyndham's rapidly expanding northwest.

With Tarneit's population set to exceed 100,000 residents by 2036, there is a significant need for accessible indoor courts to support basketball, netball, volleyball, and other community sports.

This facility will provide much-needed capacity for local sporting associations, schools and community groups.

The Tarneit Indoor Sports Facility is proposed to feature six indoor multi-use sport courts, a regional gymnastics centre, multi-purpose dry programming rooms, community events space, café, operator and sport administration office areas and associated amenities.

The proposed site is located on the fringe of the future Tarneit Major Town Centre, and within a Civic Precinct containing a Level 2 Community Centre and Town Square.



Saltwater Reserve Pavilion

Request:

\$5 million funding towards the redevelopment of the Saltwater Reserve Pavilion

About the Project:

Saltwater Reserve is one of Wyndham's most important sporting and community assets, serving thousands of residents across Point Cook and surrounding suburbs. The reserve has a range of bookable spaces, to cater for activities including sporting events, fitness classes, community meetings and educational classes.

The proposed redevelopment delivers a second story to the existing building which will provide improved facilities including:

- 300 Seat function centre with capacity for community, cultural and religious events
- Commercial kitchen
- Self-catering kitchen (in addition to club run kitchen) to support low-cost community functions.
- Balconies on each side of the pavilion to provide elevated views of the two grounds
- Meeting Room
- Coaches Box
- Amenities
- And additional storage

The proposal also includes re-purposed use of the ground floor, including flexible community active spaces for personal training and community groups to undertake fitness and wellbeing activities.

Point Cook Football Club received a State Government commitment of \$1.4 million towards the redevelopment of the Point Cook Football Club clubroom at the last State election and requires additional funding to deliver the next stage of the project.



Tarneit Performing Arts Centre (TPAC)

Request:

\$30 million funding to support the development of the Tarneit Performing Arts Centre. This funding request forms part of the overall funding requirement of the project.

About the Project:

The Tarneit Performing Arts Centre (TPAC) is a proposed project that will support growing demand in the Wyndham area for quality performing arts space and address a gap in available creative infrastructure in the outer western suburbs.

Despite many studies indicating that engagement in creative industries and pursuits can help to bridge social gaps and reduce feelings of isolation and loneliness, the West has limited opportunities for cultural and creative expression and practice.

This facility will deliver multiple benefits to the community, improving the health of the creative industries across western Melbourne through supporting opportunities for education and training, creating pathways for diversifying the sector, improving seat to population ratio in the arts space, improving access to theatre hire for community and local groups, and the facilities to attract larger commercial touring acts.

The centre will provide opportunities for the diversification of economic activity and employment within Wyndham, by activating the Tarneit Metropolitan Acting Centre, providing a creative and cultural focus for community events and generating opportunities for commercial activation.

The centre will bring Wyndham in line with the standards and quantity per capita of Melbourne's inner and eastern suburbs creative hubs and improve the health and wellbeing of community through improved opportunities to participate in creative expression, develop social connections and engage in recreational activity.

TPAC has already received DJSIR Creative Infrastructure funding for the planning and design, including a staged delivery model, with community consultation having also shown community support for a multi-use venue for Performing Arts.



For more information visit
www.wyndham.vic.gov.au

wyndhamcity
city. coast. country